

## Model:JAO2009

JAO2009 series is a low cost, self-powered, current switch, for overcurrent protection, current indication system. When the main circuit current value exceeds the set value, the output is on. When the main circuit current is less than the set value, the output is off.

The product is divided into three kinds of output form, namely:

- ①NPN tipo de salida del transistor de tipo de corriente continua
- ②PNP tipo de salida transistor para el tipo de corriente continua;
- ③ACA SCR tipo de salida, para el control de la alternancia tipo de corriente;

3 kinds of output can be directly connected to the PLC or relay.

(Note that for DC current control directly connected to the relay to be connected to the clamp diode. For AC current monitoring of the occasion, need to connect RC RC voltage network).

### Features:

Low cost, fully isolated, reverse output polarity protection, self-powered. Plate mounted, crimp terminal output.

### DC switch (-NPN or -PNP):

Vce voltage (off state): maximum operating voltage 30V DC

Vce voltage (off state): maximum operating voltage 30V DC

Vce voltage (reverse polarity): 1.2 VDC 100 mADC

Vce voltage (on): 1.5 VDC 120 mADC

Off leakage current: 5uA 30 VDC (typical)

### AC switch (-ACA):

Off-state voltage: RMS maximum AC 240V

Minimum maintenance current: 10mA

On-state current: Maximum continuous current 0.8A (RMS)

Off-state leakage current: up to 50uA (AC 240V)

### Technical indicators:

The transformer maintains the current twice	$\geq 350$	mA AC (RMS)
Transformer overload capacity	$5 \times I_n / 1s$	
Turn on time	max100	ms(Rated current)
Closing time	max250	ms(80% of Vce)
Action current	10/20/30/40	A (Optional)
frequency	50-400	Hz
Operating temperature	-25 ~ +70	°C
Storage temperature	-55 ~ +85	°C
weight	$\approx 50$	g

### Dimension drawing:

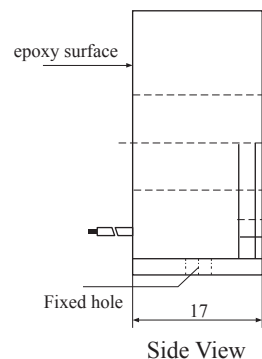
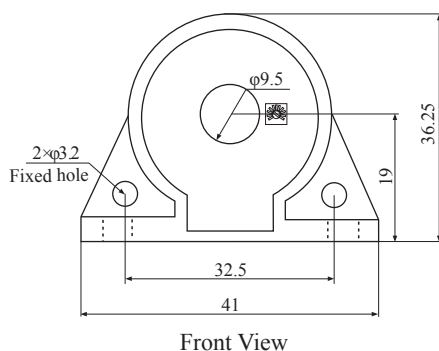

### Model definition:

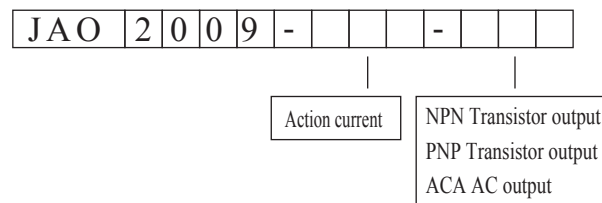

### Wiring schematic diagram:

