

Suspended type current transformer



Model:TA8431L

Characteristics:

Suspended mounting, high overload capacity. Electronics, electric power equipment current monitoring. Electric control system of current signal input. Phase loss monitoring. Monitoring the motor working condition.

Technical index:

Suspended mounting, output with cable
Material of the core: Silicon steel sheet
Flame resistance: UL94-V0
Execution standard: GB1208-2006
Operating temperature: $-35^{\circ}\text{C} \sim +85^{\circ}\text{C}$
Storage temperature: $-45^{\circ}\text{C} \sim +95^{\circ}\text{C}$
Frequency range: 50Hz \sim 60Hz
Dielectric strength: 6KV 50Hz 1min



Electrical parameters:

Rated input	0-400	A
Max.input		A
Rated output	0-0.133	A
Turns ratio	1: 3000	
Accuracy	± 1	%
Linearity	≤ 0.5	%
Phase difference		
max. Max. sampling resistance	50	Ω
Weight	210	g

Schematic diagram:

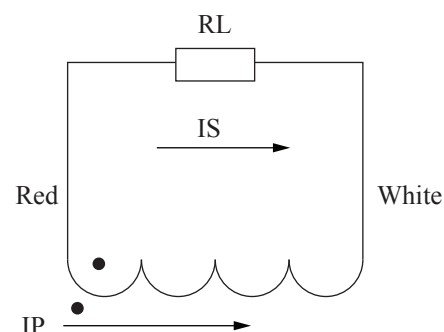

Dimensions (in mm) :

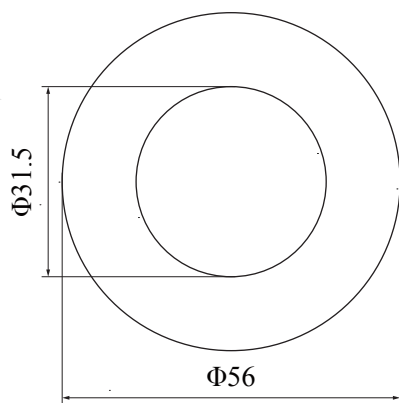

Front view

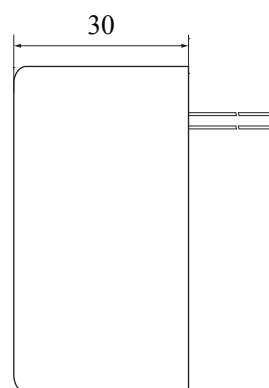

Side view